

Sunday • June 28, 2015

Hosted by: Most Holy Trinity, Veseli

Location: Metogga Lake Dairy-The Pieper Family Farm

6565 Kent Avenue, New Prague

Polka Band Playing for Mass at 1:30 p.m. – Celebrated by Bishop Lee A. Piché

featuring the Veseli Ho-Down Choir and Band

Please bring your own lawn chairs.

Some seating will be provided.

In case of rain, the celebration will go forward as planned underneath tents.

Lunch following Mass, including hot dogs, potato salad and ice cream.

Free-will offering gratefully accepted.

Activities and Entertainment:

- Music • Kids' games and activities • See the animals

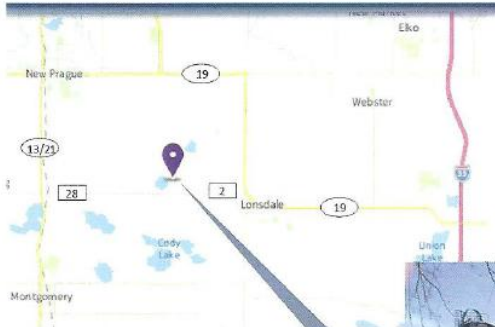

Directions:

From I 35, exit on MN-19 at Exit 69 and travel west on MN-19 for 8 miles. Right after you pass through Lonsdale, turn left on County Hwy 2/70th Street W. After 2.5 miles turn right on Kent Avenue. The location is one-half mile on the right.

From New Prague, travel south on Highway 13/21 for 4 miles towards Montgomery. Turn left on County Hwy 28/320th Street and head east for 4.5 miles. (County Hwy 28/320th Street will change to County Hwy 2/70th Street W.) Turn left on Kent Avenue; the location is one-half mile on the right.



United in Faith, Hope and Love